

PHYWE Systeme GmbH & Co. KG
Robert-Bosch-Breite 10
37079 Göttingen

Telefon +49 (0) 551 604-0
Fax +49 (0) 551 604-107
E-mail info@phywe.de

Einräum-Übersicht
General map to fill

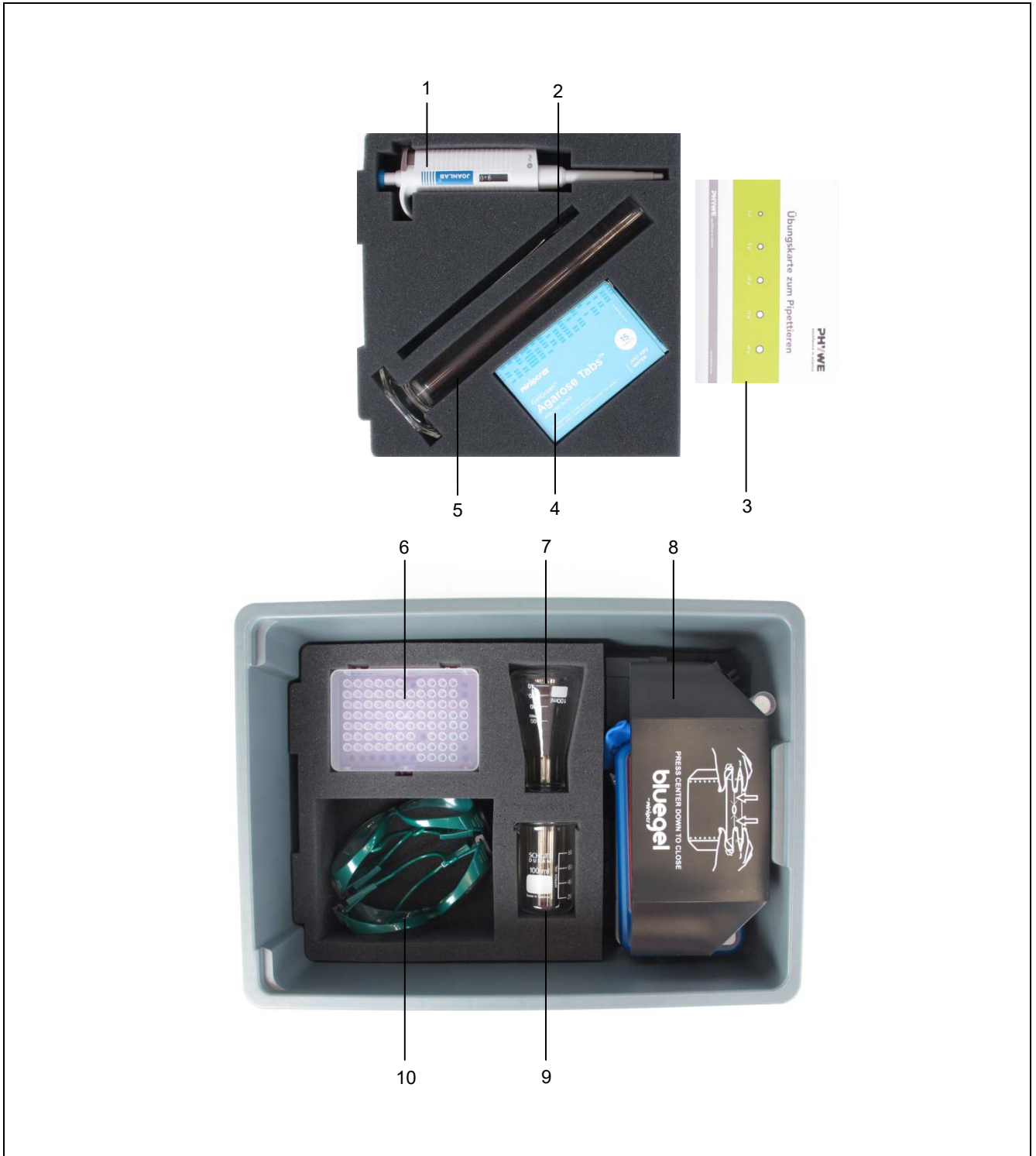

Nr. No.	Menge Qty.	Deutsch	English	Art.-Nr. Art. No.
		TESS advanced Biologie Set Genetik, GEN	TESS advanced Biology set Genetics, GEN	15311-88
1	1	Mikroliterpipette 2-20 µl	Microliterpipette 2-20 µl	47141-10
2	1	Löffelspatel, l = 180 mm	Spoon spatula, l = 180 mm	33392-00
3	1	Übungskarte zum Pipettieren	Pipetting-practice card	35005-00
4	1	3-in-1 Agarose Tabletten, 15 Stück	3-in-1 agarose tablets, 15 pieces	35018-61
5	1	Messzylinder, Boro, hohe Form, 100 ml	Graduated cylinder, 100 ml	36629-00
6	1	Spitzen, (PP), in Box, 2-200 µl, gelb, 96 Stück	Pipette tips, 2-200 µl, 96 tips, racked	47148-11
7	1	Erlenmeyerkolben, Boro, Weithals, 100 ml	Erlenmeyer flask, wide neck, 100 ml	46151-00
8	1	blueGel Gel - Elektrophoresekammer	blueGel gel - electrophoresis unit	35016-99
9	1	Becherglas, Boro, niedrige Form, 100 ml	Beaker, low form, 100 ml	46053-00
10	2	Laborschutzbrille - OneSize, Unisex	Protecting glasses, clear glass	39316-00